

HAMMERTON

SPECIFICATION DRAWING

Location:

Product #: CH7174

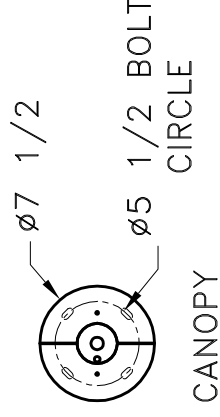

ø7 1/2

ø5 1/2 BOLT
CIRCLE

CANOPY

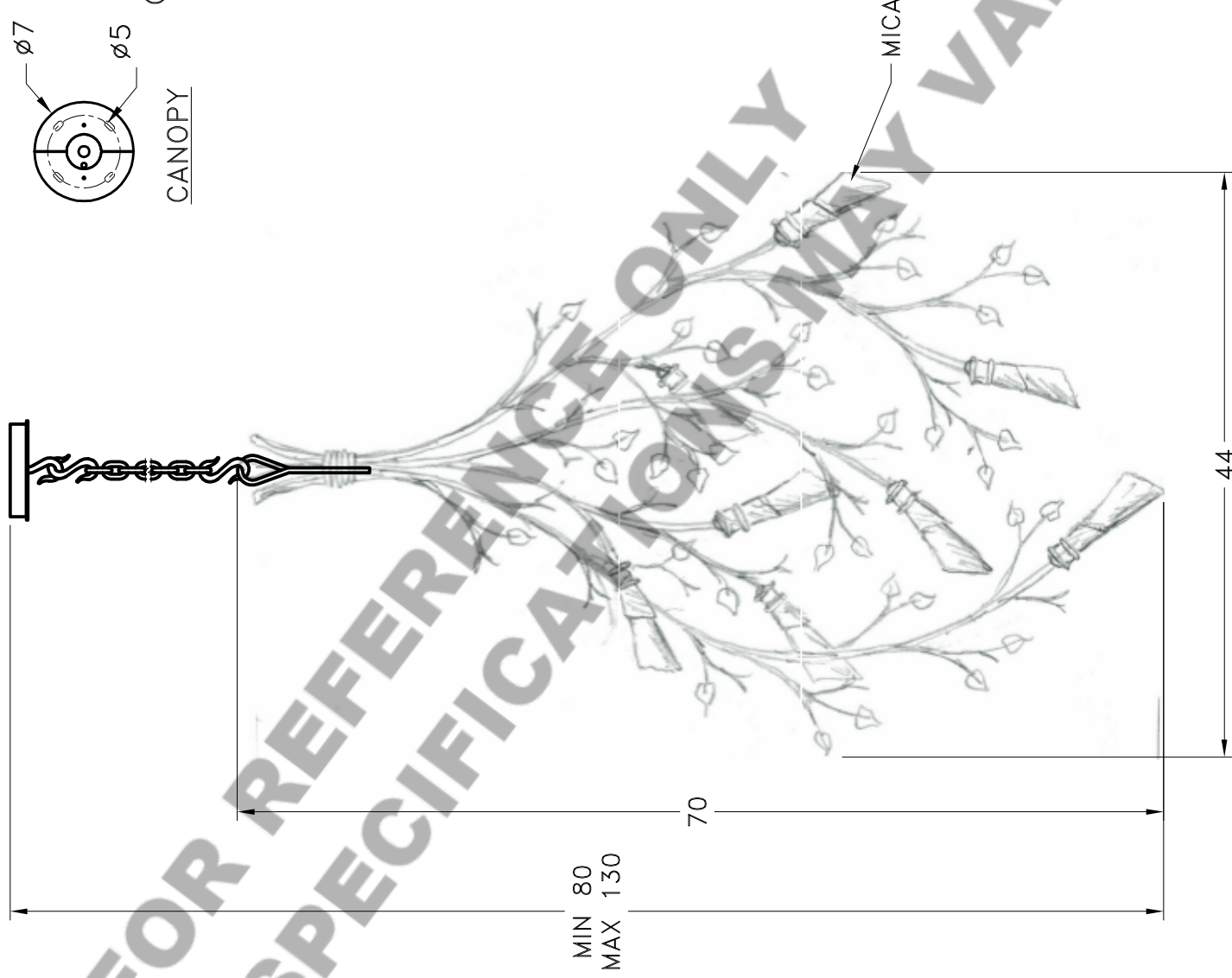

MIN 80
MAX 130

70

44

MICA

Visit hammerton.com for product options.

Mounting Packet: A	Electrical Type: INCANDESCENT
Approximate lbs.: 200	Bulb Qty: 8 Wattage: 60
Finish: SEE WEB SITE FOR OPTIONS	Voltage: 120
Top Diffuser: CLOSED	Socket Type: E12
Bottom Diffuser: OPEN	UL Location: DRY

Mounting Detail

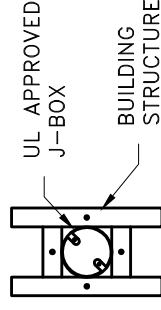

CAUTION
HARDWARE PACKET "A"
MOUNTS DIRECTLY TO
BUILDING STRUCTURE.

All fixtures created by Hammerton are handcrafted by artisans. Dimensions may vary up to 1/8".

©Copyright 2018. All rights in design, detail or invention of this drawing are reserved as the property of Hammerton. Any limitation or adaptation without written consent is strictly prohibited.

Hammerton Inc. · 217 Wright Brothers Dr. · Salt Lake City, UT 84116 · (801) 973-8095